

CLARKE®

WOODWORKER



10" (250MM) TABLE SAW

MODEL NO: CTS18

PART NO: 6500749

OPERATION & MAINTENANCE INSTRUCTIONS



ORIGINAL INSTRUCTIONS

GC0324

INTRODUCTION

Thank you for purchasing this CLARKE product. This table saw has been designed to perform the sawing operation of ripping, cross-cutting, bevelling and mitering wood and wood products. This unit is designed for use with an 10" (250mm) carbide tipped blade. This saw is NOT suitable for cutting:

- Timber greater than 70mm
- Metal, stone, rubber, plastic etc
- Logs or round timber

Before attempting to use this product, please read this manual thoroughly and follow the instructions carefully. In doing so you will ensure the safety of yourself and that of others around you, and you can look forward to your purchase giving you long and satisfactory service.

GUARANTEE

This product is guaranteed against faulty manufacture for a period of 12 months from the date of purchase. Please keep your receipt which will be required as proof of purchase.

This guarantee is invalid if the product is found to have been abused or tampered with in any way, or not used for the purpose for which it was intended.

Faulty goods should be returned to their place of purchase, no product can be returned to us without prior permission. This guarantee does not effect your statutory rights.

ENVIRONMENTAL RECYCLING POLICY



By purchasing this product, the customer is taking on the obligation to deal with its safe disposal in accordance with the Waste Electrical and Electronic Equipment (WEEE).

In effect, this means that this product must not be disposed of with general household waste but according to the laws governing Waste Electrical and Electronic Equipment (WEEE) at a recognised disposal facility.

If disposing of this product or any damaged components, do not dispose of with general waste. This product contains valuable raw materials. Metal products should be taken to your local civic amenity site for recycling of metal products.

SPECIFICATIONS

Model	CTS18
Voltage	230V - 50 Hz
Power input	1800 W
No-load speed	5000 rpm
Duty cycle classification	S1 (continuous)
Ingress protection (IP) rating	IPX0
Table size	630 mm x 905 mm
Dust Extractor connector	34.9 (internal) / 39.5 mm (external)
Blade size:	Outside Diameter 250 mm
	Bore Diameter 30 mm
	Thickness 2.8 mm
	Number of teeth 24 TCT
Maximum cut depth @ 90 Degrees	85 mm
Maximum cut depth @ 45 Degrees	65 mm
Machine weight:	19.3 kg
Machine size (H x D x W) mm	960 x 630 (inc guard) x 905mm (max)
Machine footprint (W x D)	583 x 563 mm
Sound pressure level LpA	94 dB (A)
Guaranteed sound power level LWA:	107 dB (A)
Uncertainty factor (k)	3.0

SAFETY WARNINGS



CAUTION: ENSURE DUE CARE AND ATTENTION WHEN OPERATING THIS EQUIPMENT. FAILURE TO FOLLOW THE INTRUCTIONS IN THIS MANUAL MAY LEAD TO SEVERE INJURY

PERMITTED USAGE

The table saw is constructed exclusively for the sawing of wood. The appropriate saw blade should be fitted according to the wood type (solid wood, chipboard or plywood).

- Read and understand the entire owner's manual before attempting assembly or operation.
- Read and understand the warnings posted on the machine and in this manual. Failure to comply with all of these warnings may cause serious injury.

HEALTH

When sawing, dust particles will be produced which in some instances can be harmful (e.g. lead from old gloss paint, arsenic and chromium from chemically treated lumber).

To reduce the risk you should:

- Work in a well-ventilated area.
- Work with approved safety equipment such as dust masks that are specially designed to filter microscopic particles.
- If possible use/connect to a suitable dust extractor.

GENERAL

1. **DO NOT** expose the saw to rain.
2. **DO NOT** use the saw in damp or wet conditions.
3. Keep the work area well lit.
4. **DO NOT** use the saw in the presence of flammable liquids and gases.
5. Remove loose items and unnecessary work pieces from the area before starting the saw.
6. Clean out sawdust from the interior of the saw to prevent a potential fire hazard. Attach a vacuum cleaner to the dust port for additional sawdust removal.

7. Wear ear protectors (plugs or muffs) during extended periods of operation.
8. Wear safety glasses. Everyday eyeglasses are not suitable as safety glasses.
9. Wear a dust mask when sawing wood.
10. **NEVER** wear gloves during operation.
11. Before operating this table saw, remove any neck tie, rings, watches and other jewellery and roll sleeves up past the elbows. Remove all loose clothing and confine long hair. Non-slip footwear or anti-skid floor strips are recommended.
12. Make sure that the machine stands stable on a firm, flat, level surface.
13. Before use, carefully check the saw and mains cable for damage or any other condition that may affect its operation. **DO NOT** use the saw if any part is damaged or defective.
14. **DO NOT** use the saw if the switch does not turn it on and off.
15. Remove keys and wrenches. Ensure that keys and wrenches are removed from the saw before turning it on following blade replacement.
16. Use the right tool for the task - **DO NOT** force small tools to do the job of a heavy duty tool. It will do the job better and safer at the rate for which it was intended. **DO NOT** use tools for purposes not intended; for example **DO NOT** use table saws to cut tree limbs or logs.
17. The use of any accessory or attachment other than one recommended in this instruction manual may present a risk of personal injury.
18. Connect table saws to a dust-collecting device when sawing wood.
19. Guard against electric shock - Avoid body contact with earthed or grounded surfaces.
20. Extension cables - Before use, inspect the extension cable and replace if damaged.
21. Avoid unintentional starting. Make sure the switch is in the OFF position before connecting the machine to the power supply.
22. **DO NOT** abuse the cable. **NEVER** yank the cable to disconnect it from the mains supply. Keep the cable away from heat, oil, water and sharp edges.
23. This table saw is designed and intended for use by properly trained and experienced personnel only. If you are not familiar with the proper and safe operation of a table saw, **DO NOT** use until proper training and knowledge have been obtained.
24. Stay alert and watch what you are doing. Use common sense. **DO NOT** operate the saw when you are tired or under the influence of drugs, alcohol or medication.
25. Keep hands clear of the saw blade.

26. Maintain a balanced stance at all times so that you do not fall on to the blade. **DO NOT** overreach or use excessive force to perform any operation.
27. Use push-sticks or push blocks to feed the workpiece past the saw blade. Keep your hands and fingers well away from the blade.
28. The push-stick should always be stored with the machine when not in use.
29. Pay particular attention to instructions on reducing risk of kickback on page 8.
30. **NEVER** perform any operation freehand, which means using only your hands to support or guide the workpiece. Always use either the fence or the mitre fence to position and guide the work.



WARNING: FREEHAND CUTTING IS THE MAJOR CAUSE OF KICKBACK AND FINGER AMPUTATIONS.

31. Give your work undivided attention. A lack of due care can result in serious injury.
32. When not in use, store the saw in a dry place out of reach of children and animals.
33. Replace the warning labels if they become obscured or removed.
34. Turn off and unplug the saw before cleaning. Use a brush or compressed air to remove chips or debris — **DO NOT** use your hands. Eye protection should be used when using compressed air.
35. Disconnect the saw from the mains supply before changing blades or carrying out maintenance.
36. Keep blades sharp and clean for better and safer performance. Inspect power cables periodically and if damaged have them repaired.
37. Repairs should only be carried out by qualified persons using original spare parts, otherwise this may result in considerable danger to the user.
38. Keep handles dry, clean and free from oil and grease.
39. Unplug the saw - switch off and wait for the blade to come to a complete standstill before leaving it unattended.

ADDITIONAL SAFETY RULES FOR TABLE SAWS

1. The thickness of the saw blade must be greater than the thickness of the riving knife.
2. **DO NOT** stand on the table saw.

3. During transportation make sure that the upper part of the saw blade is covered by the guard.
4. **DO NOT** use the guard for handling or transportation.
5. Check that the workpiece is properly supported. Always provide additional support for long workpieces.
6. **DO NOT** exert side pressure on the saw blade.
7. Make sure that the blade rotates in the correct direction and that the teeth are pointing to the front of the saw.
8. **DO NOT** apply lubricants to the blade when it is running.
9. **NEVER** reach around or over the saw blade. **NEVER** reach for a workpiece until the saw blade has completely stopped.
10. Make sure that the blade and retaining discs are clean. Tighten the retaining bolt securely.
11. Keep the saw blade sharp.
12. Make sure that the riving knife is adjusted to the correct distance from the blade.
13. **NEVER** operate the saw without the guard in place.
14. **DO NOT** use abrasive discs or diamond cutting wheels.
15. Rebating, slotting or grooving is not allowed.
16. **DO NOT** use a moulding head cutter with this saw.
17. Remove the rip fence when crosscutting. **NEVER** use the rip fence as a cut-off gauge when crosscutting.
18. Knock out any loose knots from the workpiece before you begin to cut.
19. Provide adequate support to the rear and the sides of the saw table for long or wide workpieces.
20. Before using the saw on an actual workpiece, let it run for a few moments. Watch for vibration or wobbling that could indicate poor installation or a poorly balanced blade.
21. **ALWAYS** hold work firmly against the mitre gauge or rip fence.
22. **NEVER** stand or have any part of your body in line with the path of the saw blade. keep your hands out of the saw blade path.
23. Feed work into the blade against the direction of rotation only.
24. **NEVER** attempt to free a stalled saw blade without first turning the saw off. Turn the power switch off immediately to prevent motor damage.
25. Avoid awkward operations and hand positions where a sudden slip could cause your hand to move into the saw blade.

26. Avoid abrupt, fast feeding. Feed as slowly as possible when cutting hard workpieces. **DO NOT** bend or twist the workpiece while feeding. If you stall or jam the blade in the workpiece, turn the table saw off immediately. Unplug the saw, then clear the jam.
27. **NEVER** remove cut-off pieces near the blade or touch the blade guard while the blade is running.

SAW BLADES

1. The maximum speed of the saw blade must always be equal to or greater than the no-load speed of the table saw as specified on the rating plate.
2. Only use saw blades recommended by the manufacturer and which are the exact bore and diameter required for this machine. **DO NOT** use any spacers to make a blade fit onto the spindle. Use only the blades specified in this manual.
3. Clean the spindle, retaining discs (especially the installing surface) and retaining bolt before installing the blade. Poor installation may cause vibration/wobbling or slippage of the blade.
4. **DO NOT** use saw blades which are damaged or deformed.
5. Take care that the selection of the saw blade is suitable for the material to be cut.
6. Make sure the blade is not contacting the riving knife or workpiece before the switch is turned on.
7. Wear gloves when handling saw blades and rough material. Saw blades shall be carried in a holder whenever practicable. **Take care that gloves can catch on rotating blades.**

KICKBACK

Kickback is a sudden reaction to a pinched, bound or misaligned saw blade, it causes the workpiece to be ejected from the tool back towards the operator. Kickback can lead to serious personal injury.

You can avoid kickbacks by:

- a. Keeping the blade sharp
- b. Keeping the rip fence parallel to the blade
- c. Keeping the riving knife and blade guard in place and operating properly
- d. Not releasing the workpiece until you have pushed it all the way past the blade
- e. Not ripping a workpiece that is twisted or warped or does not have a straight edge to guide along the fence.







If you do not have a clear understanding of kickback and how it occurs, **DO NOT** use the table saw.

REMAINING HAZARDS

The machine has been built in accordance with recognized safety standards but some remaining hazards may still exist.

These can be minimized by following the instructions in the operating manual.

SAFETY SYMBOLS

	Read instruction manual before use		Wear dust mask
	Wear safety glasses		Wear ear defenders
	Indoor Use Only		Danger of cut hand injury. Ensure guards are in place.

The above safety symbols appear on the product.

ELECTRICAL CONNECTIONS



WARNING! READ THESE ELECTRICAL SAFETY INSTRUCTIONS THOROUGHLY BEFORE CONNECTING THE PRODUCT TO THE POWER SUPPLY.

Before switching on, ensure the voltage of your electricity supply is the same as that indicated on the rating plate. This product is designed to operate on 230VAC 50Hz. Connecting it to any other power source may cause damage.

This product may be fitted with a non-rewireable plug. If it is necessary to change the fuse in the plug, the fuse cover must be refitted. If the fuse cover becomes lost or damaged, the plug must not be used until a suitable replacement is obtained.

If the plug has to be changed because it is not suitable for your socket, or due to damage, it should be cut off and a replacement fitted, following the wiring instructions shown below. The old plug must be disposed of safely, as insertion into a mains socket could cause an electrical hazard.



**WARNING: THE WIRES IN THE POWER CABLE OF THIS PRODUCT ARE COLOURED IN ACCORDANCE WITH THE FOLLOWING CODE:
BLUE = NEUTRAL BROWN = LIVE**

If the colours of the wires in the power cable of this product do not correspond with the markings on the terminals of your plug, proceed as follows.

- The **Blue** wire must be connected to the terminal marked **N** or coloured **Black**.
- The **Brown** wire must be connected to the terminal marked **L** or coloured **Red**.

Plug must be BS1363/A approved.

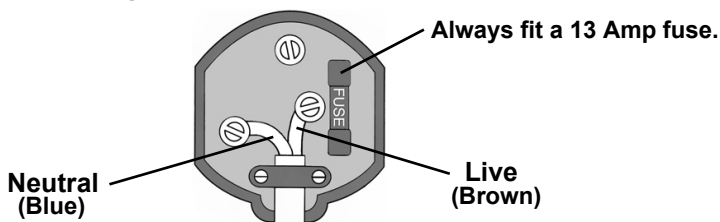

Ensure that the outer sheath of the cable is firmly held by the clamp

We strongly recommend that this machine is connected to the mains supply via a Residual Current Device (RCD).

If in any doubt, consult a qualified electrician. DO NOT attempt any repairs yourself.



This symbol indicates that this is a Class II product and does not require an earth connection.

COMPONENT OVERVIEW

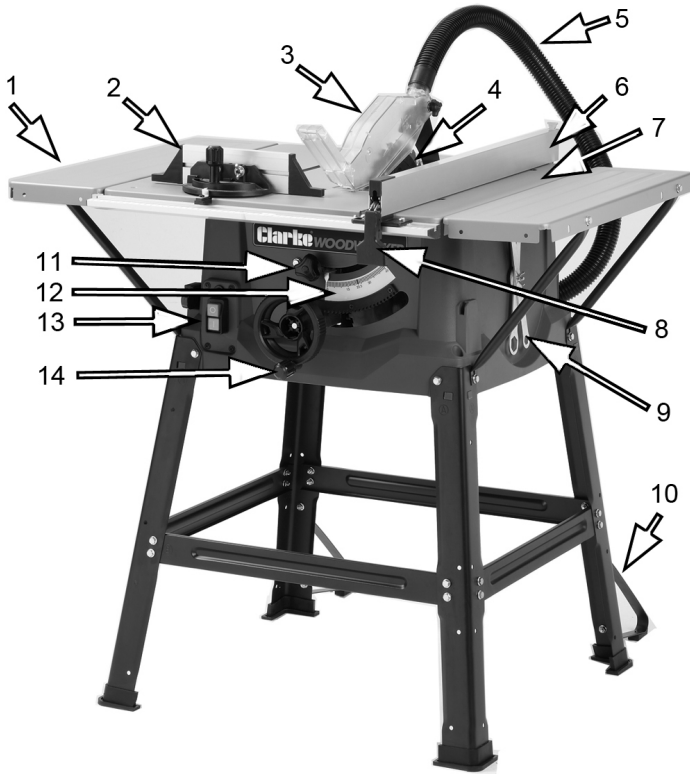

1	Table extension	9	Blade removal wrenches
2	Mitre square assembly	10	Stand stabilisers
3	Blade guard	11	Tilt adjusting knob
4	Blade	12	Tilt angle scale
5	Dust extract duct	13	On/off switch
6	Parallel guide fence assembly	14	Height adjusting handle
7	Work table	n/a	Push stick (on far side of machine)
8	Fence securing handle/clamp		

ASSEMBLY

The following items should be supplied in the carton. If any parts are missing, do not use your table saw until the missing parts are obtained.

Table Saw machine	Push Stick
Parallel Guide Fence assembly	10" TCT Saw Blade (fitted)
Mitre Guide/fence	Dust extract duct
Blade Guard Assembly	Ring spanners (large & small)
Table extension (x 2)	
Stand components: A - 4 x Legs B - 4 x Crossmembers (2x long/2x short) C - 4 x Rubber Feet D - 2 x Stand stabilisers	Fixings Pack containing: 8 x bolts (machine body to stand) 16 x bolts/nuts/flat washers (legs to crossmembers) 4 x bolts/nuts/washers (Struts to table)

ASSEMBLING THE STAND

NOTE: The table saw can be operated without the stand if required.

1. Assemble the stand as shown by joining the crossmembers to the legs using the bolts, flat washers, and nuts supplied.

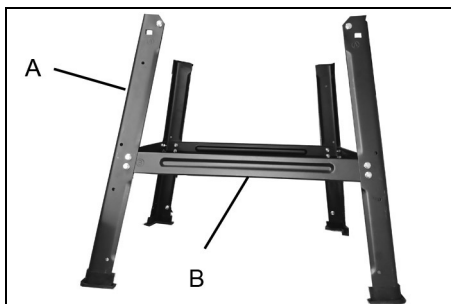

2. Press fit the rubber feet (C) to the legs.

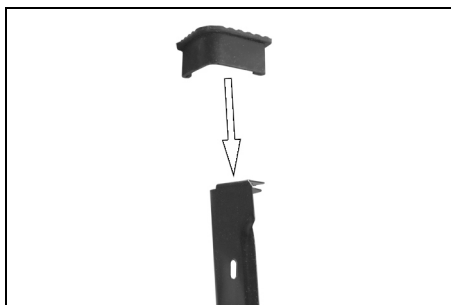

3. Attach the stabilisers (D) to the rear legs (with bolt-holes) using the coachbolts, washers and nuts supplied.

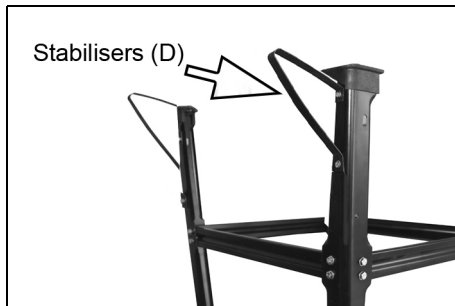

4. Fit the table saw to the stand. Secure the assemblies together by bolting the stand to the base of the machine.
5. Check that all bolts are tightened and then turn the table saw and stand over onto the feet.



FITTING THE TABLE EXTENSIONS

Bolt each table extension to the table and connect the support struts between the extension and the stand as shown by removing and re-fitting the leg bolts at each side.

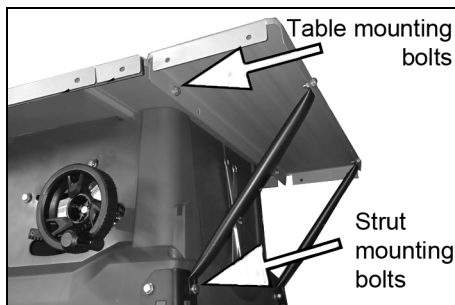

FITTING THE SLIDING SCALE

Bolt the scale to the front edge of the table using four bolts/nuts/washers.

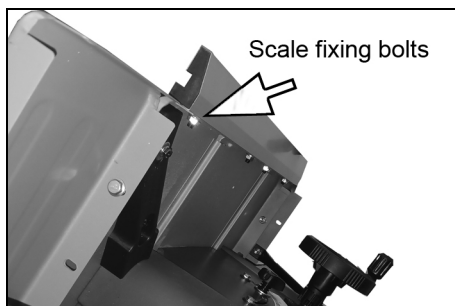

FITTING THE RIVING KNIFE AND BLADE GUARD

1. Unscrew (single small screw) and lift away the kerf plate to gain access before bolting the riving knife to the supporting bracket with the bolt/washer/nut supplied.
2. Check that it lines up with the blade and is an equal distance from the circumference of the blade.
3. Refit the kerf plate.
4. With the blade and riving knife fitted, mount the blade guard on the riving knife. Engage the socket in the guard with the slot in the riving knife and tighten the screw/locknut to pinch it to the knife, ensuring it can still move up and down when in use.

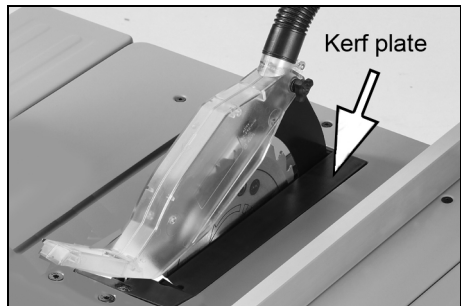
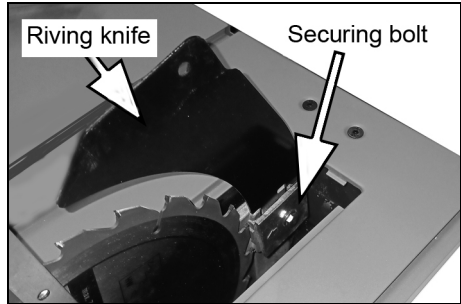

FITTING THE MITRE FENCE AND PARALLEL FENCE

1. Fit the fence to the mitre angle attachment and secure with the two wingnuts. Slide the heads of the bolts into the channel in the fence and attach the wing nuts.
2. Slide the mitre attachment into the groove in the table top.

The parallel fence is essential to ensure straight line cutting and should always be used when rip sawing. (see page 18).

The parallel fence can be mounted on either side of the blade.

1. Engage the parallel fence over the ends of the table.
2. Use the scale on the table to set the parallel fence to the required distance from the blade.
3. Lock the parallel fence in the required position by pressing down the locking handle at the end.

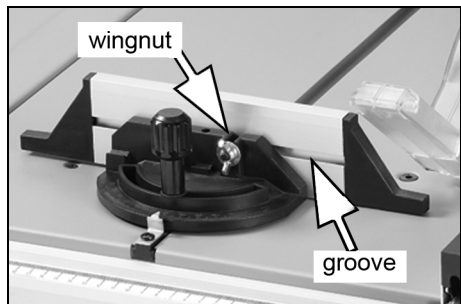

The fence may be set at any suitable position on the table to either left or right of the saw blade.

- Measurement scales (in mm) are provided at the front and back of the table. These may be used to position the rip fence for rough cutting. If precision is required, use a ruler between the rip fence and the front and back of the blade.

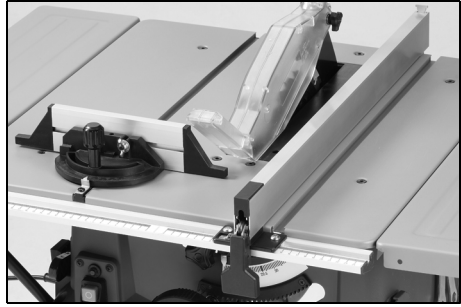

CONNECTING THE DUST EXTRACT HOSE

The table saw is equipped with a dust extraction port. Press-fit the dust extract hose to the blade guard at one end and to the extract duct at the other.

For safe operation, we recommend that a suitable dust extraction device or vacuum cleaner is connected during operation.

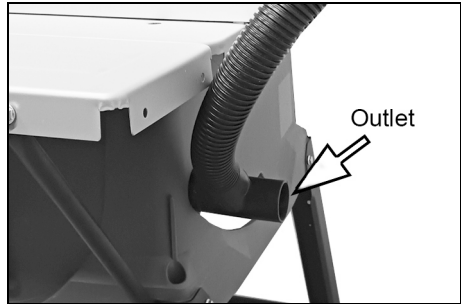

WARNING: EXCESSIVE SAWDUST BUILD UP AROUND THE MOTOR COULD POSSIBLY IGNITE AND CAUSE DAMAGE TO THE MOTOR, TABLE SAW OR YOUR WORKSHOP.

OPERATION



CAUTION: BEFORE STARTING UP THE SAW ALWAYS CHECK THE FOLLOWING POINTS:

1. Is the saw blade firmly tightened and can the blade rotate freely?
2. Are all the locking levers firmly locked?
3. Is the riving knife aligned with the saw blade?
4. Is the blade guard fitted?
5. Make sure that the fences are not touching the blade.
6. Are any wood pieces jammed between saw blade and table?
7. Have all loose workpieces been removed from the table?
8. Have all the setting tools been removed?
9. Wear protective goggles, ear protection and dust mask.

BEFORE STARTING WORK

The blade cover guard must be properly fitted before switching on.

When working with wood that has been used before, take care to remove any foreign bodies such as nails or screws etc before cutting.

Always stand the table saw on a flat and firm surface.

USE OF THE ON/OFF SWITCH/RESET

1. To turn the saw on, press the green button "I".
 - Wait for the blade to reach its maximum speed before making the cut.
2. To turn the saw off again, press the red button "0".

NOTE: The blade will spin for several seconds after the machine is switched off.

NOTE: The guard must always be lowered over the workpiece before you begin to cut.

The ON/OFF switch incorporates a reset button.

This can be pressed to re-start the machine if the thermal protection circuit has been tripped by heavy use.

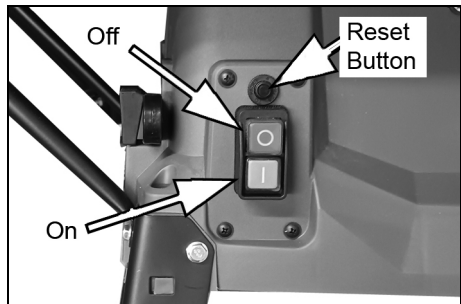

ADJUSTMENTS

After every new adjustment we recommend you to make a trial cut in order to check the new settings.

PARALLEL FENCE

The parallel fence can be mounted on either side of the table. If you change the side you will need to fit the fence the other way round.

1. Engage the parallel fence over the ends of the table.
2. Use the scale on the table to set the parallel fence to the required distance from the blade.
3. Lock the parallel fence in the required position by tightening the locking handle at the end.

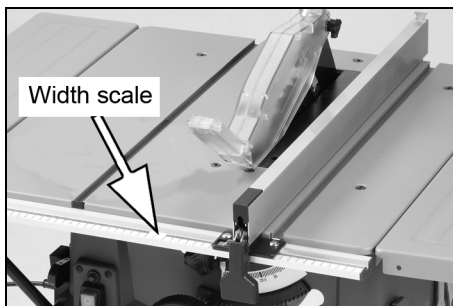

MITRE GAUGE

1. Insert the guide bar into the groove in the table top.
2. Loosen the knob to set the angle required.
3. Rotate until the pointer points to the angle on the scale you want.
4. Retighten the knob.
 - If required you can remove the fence from the mitre assembly using the two wingnuts or slide it in either direction to suit the task before re-tightening.

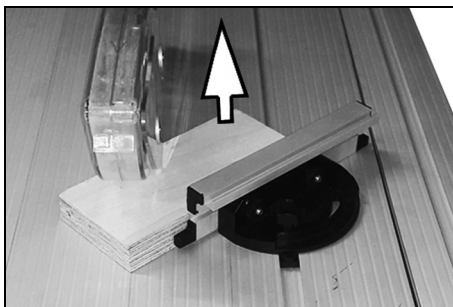

SETTING THE BLADE ANGLE

1. Release the bevel locking knob.
2. Tilt the saw blade and motor assembly until the saw blade is at the desired angle.
3. Tighten the bevel locking knob to lock the blade at the required angle shown on the scale.

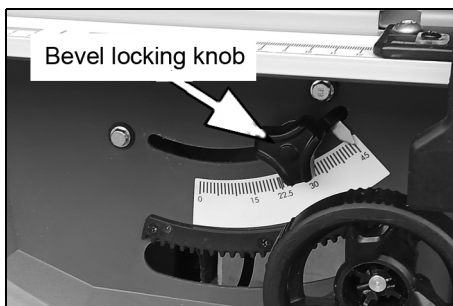

CUTTING TIPS

RIPPING CUTS & CROSS CUTS

Ripping is when you use the saw to cut along the grain of the wood.

The parallel fence must always be used when making ripping cuts.

1. Press one edge of the workpiece against the parallel fence while the flat side lies on the saw table.
 - The blade guard must always be lowered over the workpiece and blade.
 - When you make a ripping cut, never stand in line with the blade.
2. Set the parallel fence in accordance with the desired width.
3. Switch on the saw.
4. Push the workpiece along the parallel fence towards the blade.
5. Guide at the side with your left or right hand (depending on the position of the parallel fence) only as far as the front edge of the guard hood.
6. Always push the workpiece through to the end of the riving knife using a push stick.
7. Do not remove the offcut piece until the blade has stopped spinning.
8. Secure long workpieces against falling off at the end of the cut (e.g. with a roller stand etc).

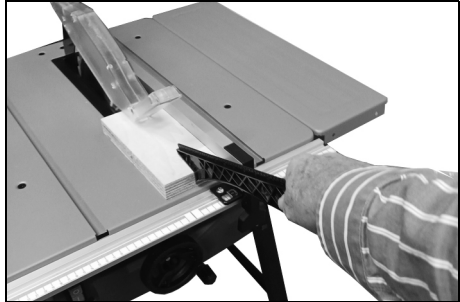

MITRE CUTS

1. Slide the mitre gauge into the groove in the table.
2. Adjust the mitre gauge to the required angle.
3. Press the workpiece firmly against the mitre gauge.

4. Switch on the saw.
5. Push the mitre gauge and the workpiece toward the blade to make the cut.

IMPORTANT: Always hold the guided part of the workpiece. Never hold the part which is to be cut off.

6. Push the mitre gauge forward until the workpiece is cut all the way through.
7. Switch off and do not remove the offcut until the blade has stopped.

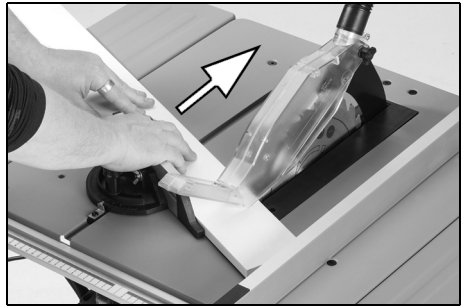

BEVEL CUTS

Bevel cuts must always be made using the parallel fence.

1. Undo the bevel lock knob and set the saw blade to the desired angle shown on the scale.
2. Tighten the bevel knob to lock the blade at the selected angle.
3. Set the parallel fence.
4. Perform the cut as you would for a ripping cut.

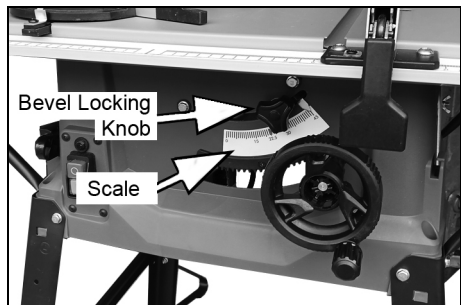

NOTE: If precision is required, use a protractor between the blade and table.



CUTTING NARROW WORKPIECES

Always use a push stick when the workpiece is narrow and for holding the workpiece flat on the table.

- Take extra care to keep your thumbs away from the saw blade when feeding the workpiece past the blade.

When not in use, store the push stick in its holder on the side of the machine.

Replace a broken or lost push stick immediately.



MAINTENANCE



WARNING: UNPLUG FROM THE MAINS POWER SUPPLY BEFORE CARRYING OUT ANY MAINTENANCE.

Your saw has been designed to operate over a long period of time with a minimum of maintenance. Continuous satisfactory operation depends upon proper tool care and regular cleaning.

NEVER use caustic agents to clean plastic parts.

1. Remove dust regularly from the machine. Cleaning is best carried out with a fine brush.
2. Regularly clean the table top.
3. Regularly clean the dust collection outlet.
4. Use a half-round file where necessary to keep the teeth sharp. A blade that is badly dulled or with damaged teeth should be replaced immediately.

CHANGING THE BLADE



WARNING: WEAR SAFETY GLOVES WHEN CHANGING THE SAW BLADE.

WARNING: THE REPLACEMENT BLADE MUST BE RATED TO AT LEAST 7000 RPM.

1. Remove the transparent blade guard.
2. Remove the kerf plate by unscrewing the securing screw.
3. Using the open spanners provided (stored on the side of the machine), hold the spindle to prevent the motor from turning and undo the saw blade securing bolt (normal thread).

4. Remove the outer retaining disc followed by the saw blade by lifting it clear of the motor shaft and carefully withdrawing it from the machine.
5. Replace in reverse order ensuring the saw blade teeth face downwards at the front of the table.

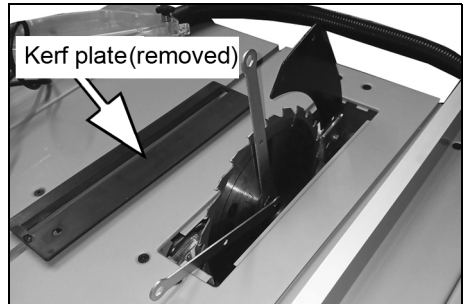

- The arrow on the face of the blade will show the rotation to be anticlockwise.
6. Hold the blade firmly when tightening the centre bolt, taking care to avoid injuring your hand on the sharp teeth.

IMPORTANT: Note the running direction. The cutting angle of the teeth must point in the running direction, i.e. forwards (see arrow on the blade guard).

7. Check that the riving knife lines up with the saw blade.
8. Refit the table insert (kerf plate) and the transparent blade guard.
9. Check that all components are properly mounted and in good working condition before you begin working with the saw again.

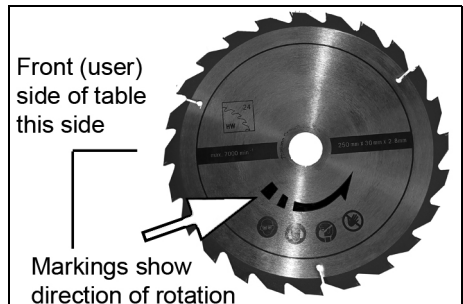

TROUBLESHOOTING

Problem	Probable cause	Solution
Machine will not run	<ol style="list-style-type: none"> 1. Machine not plugged in 2. Fuse blown 3. Power cable damaged 	<ol style="list-style-type: none"> 1. Plug in the machine 2. Replace fuse 3. Have cable replaced by your dealer.
Does not make accurate 45° and 90° cuts	<ol style="list-style-type: none"> 1. Table adjuster not set correctly 	<ol style="list-style-type: none"> 1. Check blade with a set square and adjust pointer to zero.
Material pinches blade	<ol style="list-style-type: none"> 1. Fence not aligned with blade. <ul style="list-style-type: none"> • Warped wood. • Edge not set square to fence. 	<ol style="list-style-type: none"> 1. Check and adjust fence. Select another piece of wood. 2. Select another piece of wood.
Material binds on the riving knife	<ol style="list-style-type: none"> 1. Riving knife not aligned correctly 	<ol style="list-style-type: none"> 1. Check that riving knife is correctly aligned with blade
Saw makes unsatisfactory cuts	<ol style="list-style-type: none"> 1. Dull blade 2. Blade mounted backwards 3. Gum or pitch on blade 4. Incorrect blade for work 5. Gum or pitch on table causing erratic feed 	<ol style="list-style-type: none"> 1. Replace blade 2. Turn blade around 3. Remove blade and clean with turpentine and coarse steel wool 4. Change the blade 5. Clean table with turpentine and steel wool and apply wax
Material kicked back from blade slot	<ol style="list-style-type: none"> 1. Rip fence out of alignment 2. Riving knife not aligned with blade 3. Feeding stock without rip fence 4. Riving knife not in place 5. Letting go of wood before it is all the way past the saw blade 6. Dull blade 	<ol style="list-style-type: none"> 1. Align rip fence with blade 2. Align riving knife with blade 3. Install and use rip fence 4. Install and use riving knife with guard 5. Push work fully past blade before releasing work 6. Replace blade
Blade does not tilt freely	<ol style="list-style-type: none"> 1. Sawdust in tilting mechanism 	<ol style="list-style-type: none"> 1. Brush or blow out loose dust
Blade does not come up to speed	<ol style="list-style-type: none"> 1. Extension cable too long 	<ol style="list-style-type: none"> 1. Replace or use shorter cable
Machine vibrates	<ol style="list-style-type: none"> 1. Saw not standing securely on bench 2. Damaged saw blade 	<ol style="list-style-type: none"> 1. Reposition on flat level surface 2. Replace blade.

DECLARATIONS OF CONFORMITY



Fitzwilliam Hall, Fitzwilliam Place, Dublin 2

DECLARATION OF CONFORMITY

This is an important document and should be retained.

We hereby declare that this product(s) complies with the following legislation:

- 2014/30/EU Electromagnetic Compatibility Directive
- 2006/42/EC Machinery Directive
- 2017/65/EU Restriction of Hazardous Substances (RoHS) Directive

The following standards have been applied to the product(s):

- IEC 62841-1:2014 (First Edition) + C1:2014, EN IEC 61000-3-2:2019/A1:2021, EN IEC 55014-1:2021,
- IEC 62321-4:2013+AMD1:2017, EN IEC 61000-3-11:2019, IEC 62321-5:2013, IEC 62321-7-2:2017,
- IEC 62321-7-1:2015, IEC 62321-3-1:2013, ISO 17075-1:2017, IEC 62321-8:2017, IEC 62321-6:2015,
- EN IEC 55014-2:2021

The technical documentation required to demonstrate that the product(s) meet(s) the requirement(s) of the aforementioned legislation has been compiled and is available for inspection by the relevant enforcement authorities.

The CE mark was first applied in: 2024

Product Description:	Table Saw
Model Number(s):	CTS18
Serial/Batch Number:	Refer to product/packaging label
Date of issue:	23/01/2024

Signed: 
 J.A. Clarke
 Director



Hemnell Street, Epping, Essex, CM16 4LG

DECLARATION OF CONFORMITY

This is an important document and should be retained.

We hereby declare that this product(s) complies with the following legislation:

- The Electromagnetic Compatibility Regulations 2016
- The Supply of Machinery (Safety) Regulations 2008
- The Restriction of the Use of Certain Hazardous Substances in Electrical and Electronic Equipment Regulations 2012

The following standards have been applied to the product(s):

- IEC 62841-1:2014 (First Edition) + C1:2014, EN IEC 61000-3-2:2019/A1:2021, EN IEC 55014-1:2021,
- IEC 62321-4:2013+AMD1:2017, EN IEC 61000-3-11:2019, IEC 62321-5:2013, IEC 62321-7-2:2017,
- IEC 62321-7-1:2015, IEC 62321-3-1:2013, ISO 17075-1:2017, IEC 62321-8:2017, IEC 62321-6:2015,
- EN IEC 55014-2:2021

The technical documentation required to demonstrate that the product(s) meet(s) the requirement(s) of the aforementioned legislation has been compiled and is available for inspection by the relevant enforcement authorities.

The UKCA mark was first applied in: 2024

Product Description:	Table Saw
Model Number(s):	CTS18
Serial/Batch Number:	Refer to product/packaging label
Date of issue:	23/01/2024

Signed: 
 J.A. Clarke
 Director

COMPONENT PARTS DIAGRAM

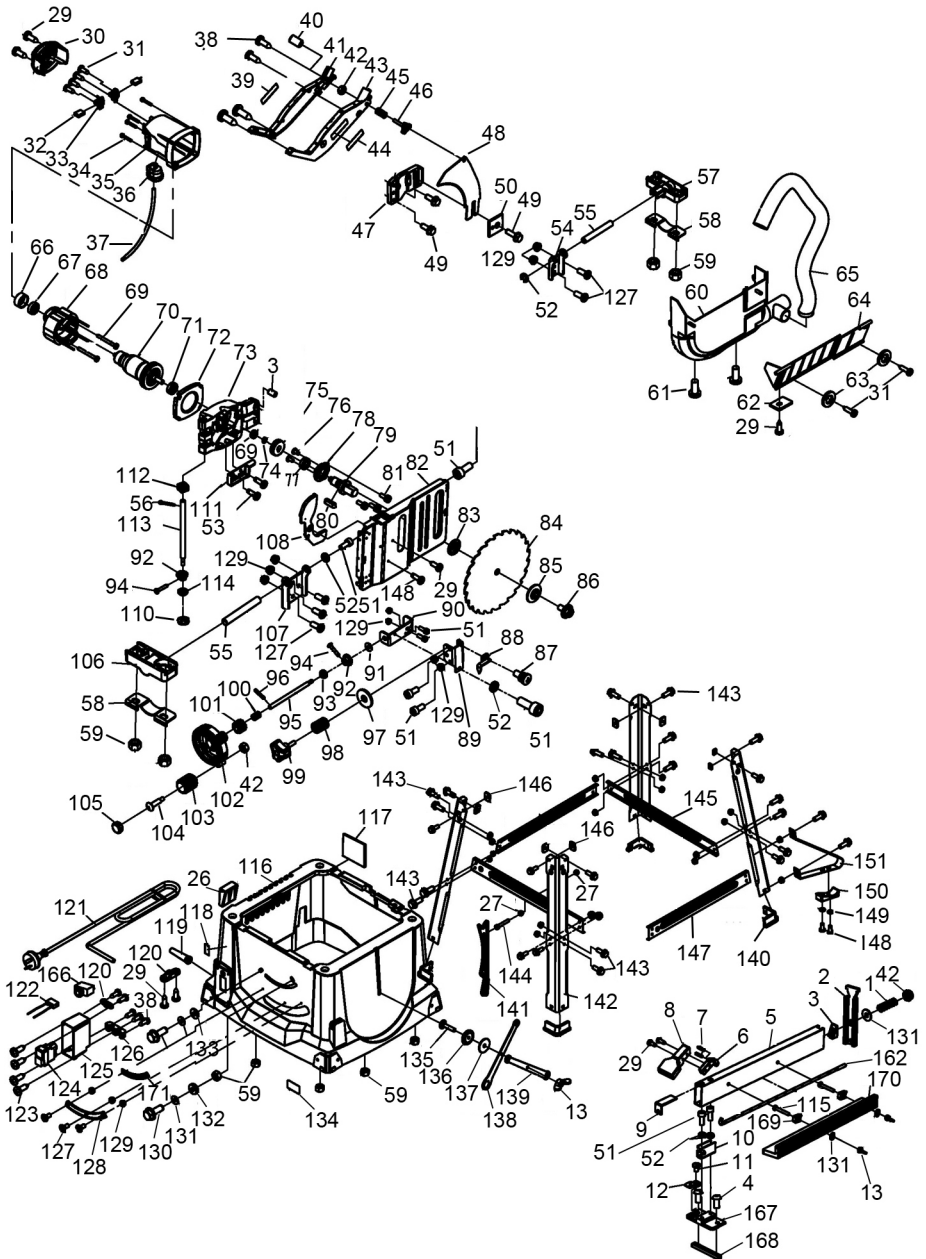

COMPONENT PARTS LIST

No	Item	No	Item	No	Item
1	Fence lock spring	31	S/t screw	61	X-head screw M6x16
2	Fence clamp plate	32	Carbon brush	62	Plate
3	Spring holder	33	Brush holder	63	Washer
4	Socket screw	34	X-head screw M5x35	64	Blade guard plate
5	Rip fence	35	Motor housing	65	Extract hose
6	Fence locking lever	36	Cable gland	66	Bearing sleeve
7	Spring pin	37	Motor cable	67	Bearing
8	Fence lock handle	38	S/t screw	68	Motor assembly
9	Fence end cap	39	Warning label	69	S/t screws
10	Fence locking block	40	Set screws M6x6	70	Armature assembly
11	Screw	41	Left blade guard	71	Bearing
12	Rip fence indicator	42	Locknut	72	Baffle
13	Wingnut	43	Right blade guard	73	Gear housing
14	X-head screw M4x5	44	Warning label	74	Circlip
15	Nut	45	Spring	75	Gear
16	Table insert	46	Locking knob	76	Screw M5x10
17	Table	47	Riving knife bracket	77	Bearing
18	Screw	48	Riving knife	78	Bearing cover plate
19	Screw	49	Hex screws M6x25	79	Arbor
20	M6 nut	50	Riving knife clamp	80	Flat key
21	Carriage bolt	51	Socket screws M5x12	81	x/head screw M5x12
22	Left end cap	52	Spring washer	82	Motor bracket
23	Left guide rail	53	Screws M4x12	83	Inner blade disc
24	Left scale	54	Rear mount plate	84	Saw blade
25	Right end cap	55	Pin	85	Outer blade disc
26	Push stick holder	56	Circlip	86	Hex bolt M8x16
27	Hex nut	57	Bevel shaft support	87	x/head screw M5x12
28	Table support block	58	Locking plate	88	Bevel indicator
29	S/t screw	59	Nut M6	89	Mounting plate
30	Motor end cap	60	Dust cover	90	Driving rod bracket

91	Washer	118	Safety label	145	Cross beam (short)
92	Bevel gear	119	Cable protector	146	Square nut
93	Driving rod bush	120	Cable clamp	147	Cross beam (long)
94	S/t screw	121	Power cable	148	x-head screws M4x8
95	Actuating arm	122	Capacitor	149	Washer
96	Spring pin	123	S/t screws	150	Stabilising foot
97	Washer	124	Switch	151	Stability support
98	Spring	125	Switch box	152	Hex bolt M6x35
99	Bevel lock knob	126	Switchbox cover	153	s/t screws
100	Spring	127	Screws M5x12	154	Rod-mitre gauge
101	Bevel gear wheel	128	Gear rack	155	Mitre indicator
102	Bevel crank wheel	129	Hex nut M5	156	s/t screws
103	Bevel crank knob	130	Hex screws M6x16	157	Mitre gauge
104	Screws M6	131	Washer	158	Knob
105	End cap	132	45 deg bush	159	End cap
106	Bevel shaft support	133	90 deg bush	160	Mitre gauge stop
107	Front mount plate	134	Logo label	161	Carriage bolt M6x25
108	Blade guard	135	Carriage bolt M6x25	162	Rip fence tie rod
109	Ext table support	136	Threaded spacer	163	Left table support
110	Locknut M8	137	Washer	164	Left extension table
111	Lower blade guard	138	Blade spanner A	165	Right table support
112	Double nut	139	Blade spanner B	166	Overload switch
113	Threaded rod	140	Rubber foot	167	Rip fence holder
114	Washer	141	Push stick	168	Fence guide block
115	Hex bolt M6x40	142	Leg A	169	Nut
116	Main casing	143	Hex screws M6x12	170	Rip fence extension
117	Data label	144	Socket screws M5x20	171	Bevel scale

TABLE COMPONENTS

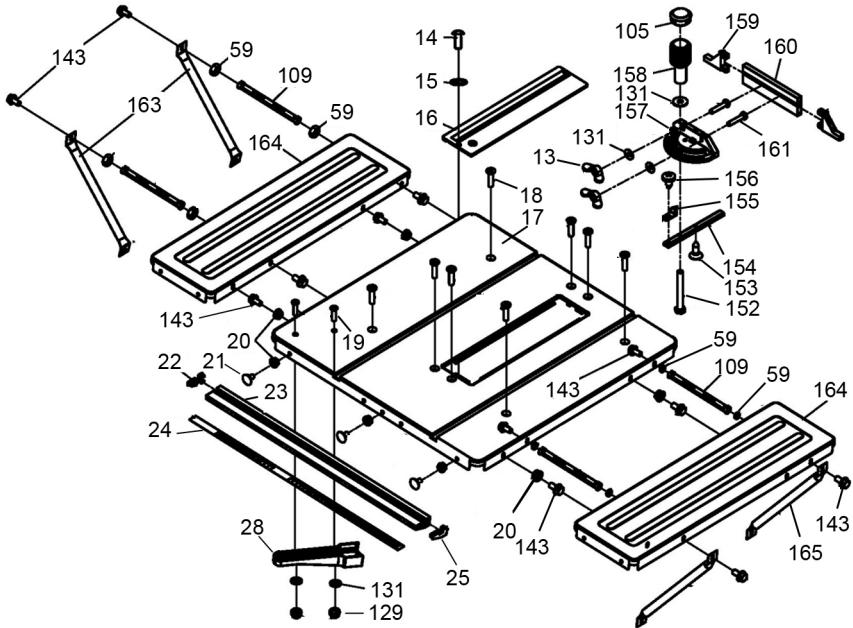

USEFUL ITEMS FROM THE CLARKE CATALOGUE

Refer to the Clarke website www.clarkeinternational.com for a full range of items for use with this saw. See also the following accessories;

10" Saw Blade(30mm bore)	Part No: 6501073
CARS1 Roller Stand	Part No: 6500980
CARS 3 in 1 Roller Stand	Part No: 6500983
CWVE2 Vacuum Dust Extractor	Part No: 6471169
CVAC20P Vacuum Cleaner	Part No: 6471100

A SELECTION FROM THE VAST RANGE OF

Clarke®

QUALITY PRODUCTS



AIR COMPRESSORS

From DIY to industrial, Plus air tools, spray guns and accessories.

GENERATORS

Prime duty or emergency standby for business, home and leisure.

POWER WASHERS

Hot and cold, electric and engine driven - we have what you need

WELDERS

Mig, Arc, Tig and Spot. From DIY to auto/industrial.

METALWORKING

Drills, grinders and saws for DIY and professional use.

WOODWORKING

Saws, sanders, lathes, mortisers and dust extraction.

HYDRAULICS

Cranes, body repair kits, transmission jacks for all types of workshop use.

WATER PUMPS

Submersible, electric and engine driven for DIY, agriculture and industry.

POWER TOOLS

Angle grinders, cordless drill sets, saws and sanders.

STARTERS/CHARGERS

All sizes for car and commercial use.

PARTS & SERVICE:

0208 988 7400

Parts Enquiries

Parts@clarkeinternational.com

Servicing & Technical Enquiries

Service@clarkeinternational.com

SALES: UK 01992 565333 or Export 00 44 (0)1992 565335

Clarke INTERNATIONAL Hemnall Street, Epping, Essex CM16 4LG
www.clarkeinternational.com